

# C800 CYLINDRICAL LEVER LOCK INSTALLATION INSTRUCTIONS

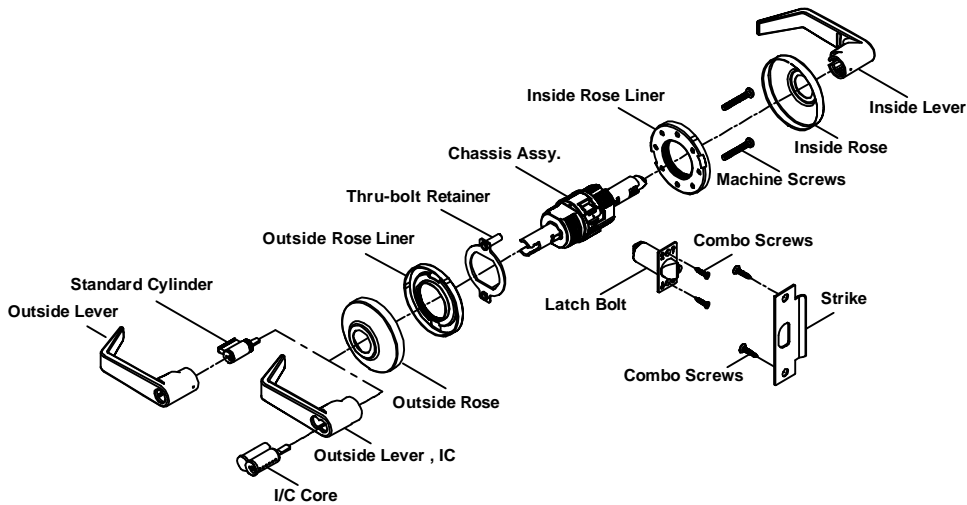

## 1. Mark Door

- Mark height line on edge of door approximately 38" from floor.
- Using the proper backset, mark 2 1/8" hole on both sides of the door.
- Mark 5/16" holes, two places on both sides of the door.
- Mark the center of the door edge for the latch.

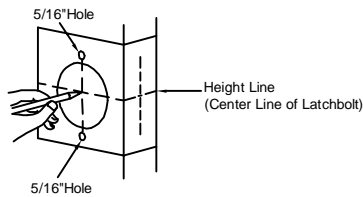

## 2. Door Preparation

- Bore 2 1/8" hole thru and two 5/16" holes from both sides of door to prevent splintering door finish.
- Bore 1" hole for latch on door.
- Using the latch faceplate as a guide, trace outline and mortise door edge so latch is flush with door.

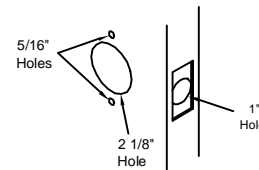

**NOTE: Hollow metal doors must be properly reinforced for lock and latch support (if support was not furnished, contact door manufacturer).**

## 3. Install Strike

- Use strike locating tool or pointed object to locate position for hole in frame.
- Bore 1" x 3/4" deep hole. Use strike as template and mortise to the proper depth.
- If dust box is to be used, clear area with wood chisel.

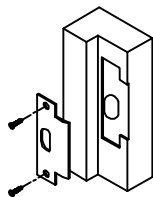

## 4. Install Latch Assembly

- Insert latch into door.
- Secure with two screws provided (4a).
- The extension must engage the latch bolt from the opposite side of the deadlocking slide (4b).

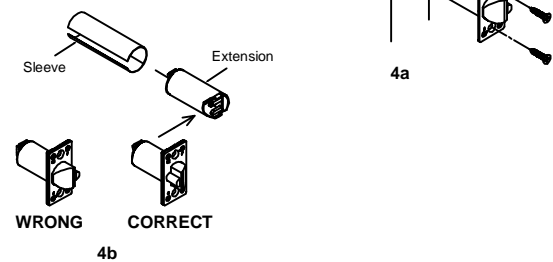

## 5. Chassis Adjustment

- For door thickness adjustment:
- Remove Thru-bolt Retainer away from outer rose assembly.
  - Rotate rose assembly to required position of door thickness.
  - Move back Thru-bolt Retainer and mate with outer mounting plate.

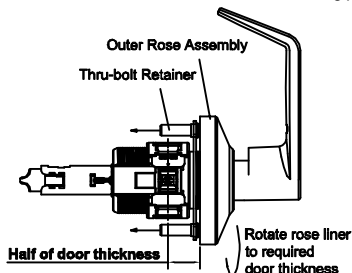

## 6. Install Outside Trim

- For ease of installation, lock should be in the unlocked position. (Figure 1)
- Slide chassis assembly into door from outside making sure that lock housing engages latch prongs. Retractor must also engage latch bar. (Figure 2)

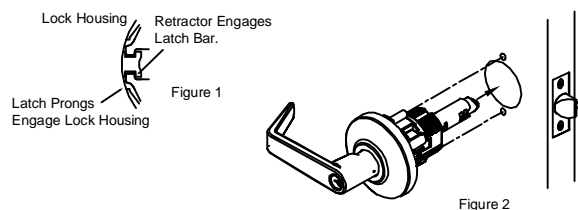

**IMPORTANT: Chassis assembly must be positioned in center of door for proper operation.**

## 7. Install Inside Trim

- Insert the spanner wrench into the notch in plate as shown and tighten the plate onto the door.
  - Insert screws and tighten.
  - Locate the notch on the edge of rose towards the bottom and push in until flush with face of door.
  - Align lever with spindle and push until lever catch engages with hole.
- E. Check function before closing door.**

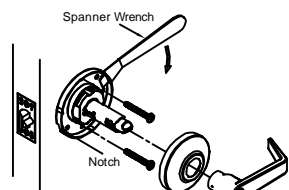

**NOTE:** Adjust either one of the notch in security mounting plate toward bottom.

## 8. Remove Lever

- For outside levers only: Turn key or button **45° clockwise** and hold.
- Depress lever catch and pull off lever and cylinder.

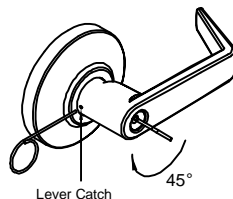

## 9. Install Cylinder into Lever

- Insert cylinder into lever.
- Insert key into cylinder to hold and align cylinder.

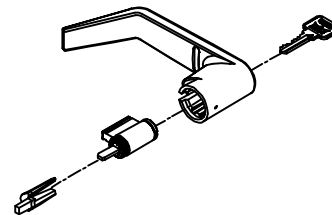

## 10. Install Cylinder & Lever

- Make sure Cylinder Spacer is put in the spindle.
  - Align hole in lever with lever catch on spindle assembly and slide lever up to lever catch.
  - For outside levers only: Turn key **45° clockwise** and hold.
  - Push lever in to engage lever catch.
- E. Check function before closing door.**

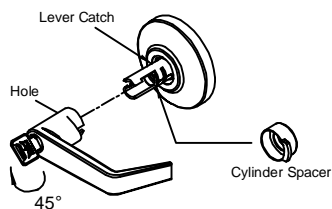

## 11. Remove IC Core

- Unlock lockset.
- Turn control key **15° clockwise** or until key stops.
- Pull key to remove IC core.

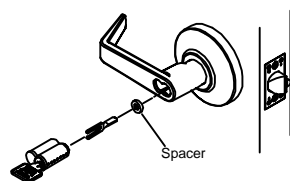

## 12. Install IC Core

- With control key in core rotate key **15° clockwise** and insert fully into lever.
- Turn the key counter-clockwise and remove key.
- Check function before closing door.**

## 13. Remove IC Lever

With IC core removed, using a screwdriver, depress lever catch and pull lever to remove.

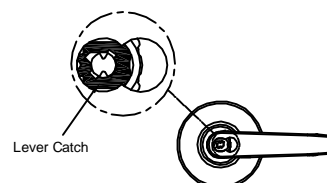

## 14. Install IC Lever

Push lever in until lever catch engages with lever.

## 15. Tailpiece Installation

- Insert spring and pin into cylinder.
  - Place tailpiece into cap.
  - Thread cap onto the cylinder.
- NOTE:** The cap must be properly adjusted. If too loose, excessive plug end play will prevent the key from being withdrawn. If too tight, the plug will drag and be difficult to rotate with the key.

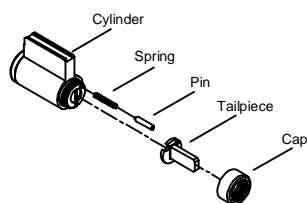

## 16. Dummy Trim Installation

### Single Dummy Trim

- Position mounting plate as required with lever catch towards door edge.
- Fasten mounting plate to door using four #8 combo screws provided.
- Install rose and lever.

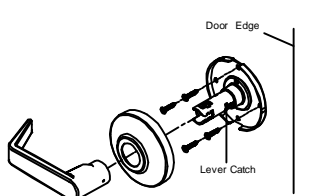

### Double Dummy Trim

- Insert the outside rose liner into the through-bolt holes. Make sure that the lever catch towards door edge.
- Align the inside rose liner and secure with the machine screws.
- Install rose and lever.

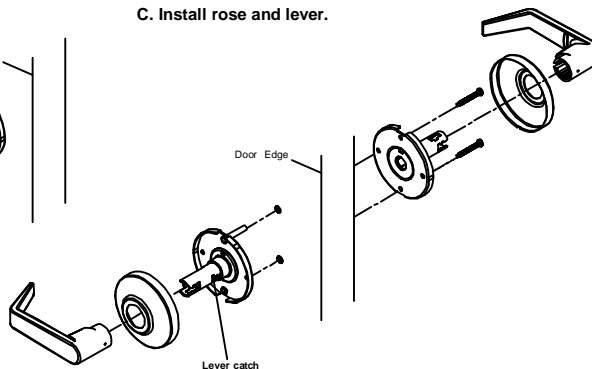

## 17. Cylinder Timing

### FOR COMMUNICATING 872 & CLASSROOM 870 & EXIT / COMMUNICATING CLASSROOM 865 FUNCTION:

- Install lock on door as shown in steps 1 thru 7.
- Using a 1/4" diameter philips screwdriver, turn CCW key spindle until stop and lever is locked.
- If IC go to **G**. Remove standard cylinder lever.
- Insert cylinder into lever as shown in step 9.
- Slide lever and cylinder onto the spindle and push the cylinder in to engage the key spindle.
- Insert key into cylinder and turn CW **45°** as shown in step 8. Go to step **H**.
- For IC: Insert cylinder into lever as shown in **step 11**.
- Check operation:  
Outside - turn key CW **360°** to unlock.  
turn key CCW **360°** to lock.

Manufactured under one or more of the following patent numbers :  
5887465 , 6532779 B2 , 6302457 B1 , 6719338 B2 and other patents pending.